

BUILDING

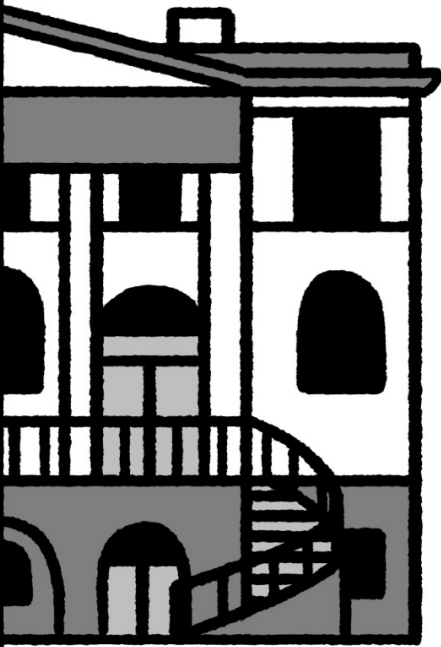

The Fireproof Building has been home to the South Carolina Historical Society since 1943. Beginning in 2014, the Society's archives were relocated to the Addlestone Library so the building could be renovated into a museum.

Join SCHS Fridays at 2PM for a
special Architectural Tour!

visit schistory.org for more details

South Carolina Historical Society
Melina Testin, Education Coordinator
melina.testin@schsonline.org



FIREPROOF

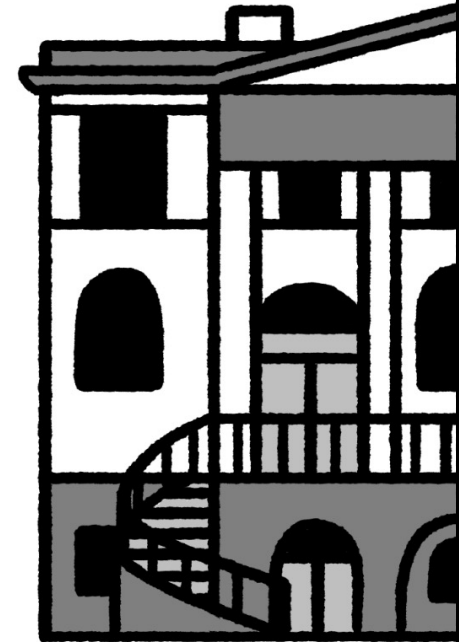

BUILDING



The Fireproof Building has been home to the South Carolina Historical Society since 1943. Beginning in 2014, the Society's archives were relocated to the Addlestone Library so the building could be renovated into a museum.

Join SCHS Fridays at 2PM for a
special Architectural Tour!

visit schistory.org for more details

South Carolina Historical Society
Melina Testin, Education Coordinator
melina.testin@schsonline.org



FIREPROOF

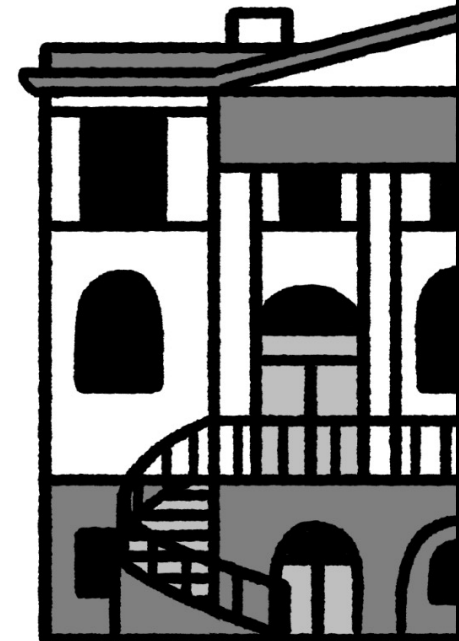

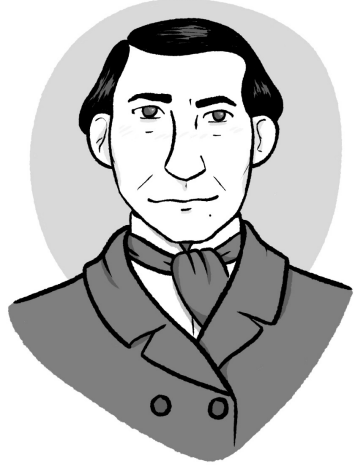

Robert Mills (1781-1855),
architect of the Fireproof
Building, was born and
trained in Charleston

What makes a building **FIREPROOF?**

cantilevered staircase and
skylight for natural light

947,500 bricks to make
walls 20 inches thick

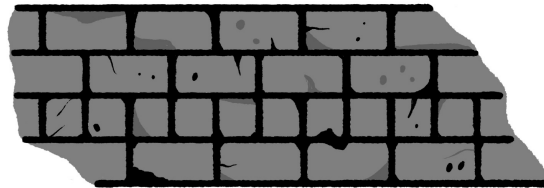

copper-coated roof



iron shutters

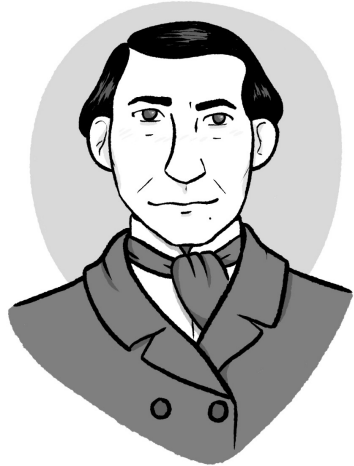
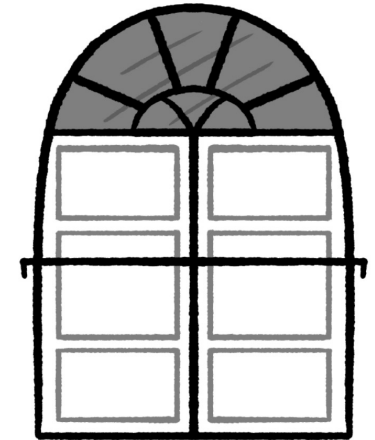

Robert Mills (1781-1855),
architect of the Fireproof
Building, was born and
trained in Charleston

What makes a building **FIREPROOF?**

cantilevered staircase and
skylight for natural light

947,500 bricks to make
walls 20 inches thick

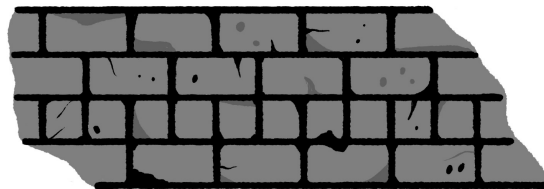

copper-coated roof



iron shutters

